

REPLACEMENT PARTS LIST

SINGLE PACKAGE HEAT PUMP
Q6SE SERIES
14 SEER, 3-PHASE, 460V MODELS



IMPORTANT

- This document is primarily intended to assist qualified individuals experienced in the proper repair or servicing of this appliance. Only factory authorized parts or accessory kits may be used with this product. Improper installation, service, adjustment, or maintenance may cause explosion, fire, electrical shock or other hazardous conditions which may result in personal injury or property damage.
- Some local codes require licensed installation / service personnel to service this type of equipment. Under no circumstances should the equipment owner attempt to install parts or service this equipment. Failure to comply with this warning could result in property damage, personal injury, or death.

**Q6SE SINGLE PACKAGE HEAT PUMP
3-PHASE, 460V, 14 SEER MODELS**

DESCRIPTION	Q6SE-X36D	Q6SE-X48D	Q6SE-X60D
	1014899	1014900	1014901
ACCUMULATOR	668853R	668854R	668854R
AMBIENT SENSOR	626551R	626551R	626551R
BLOWER MOTOR (1/2 HP, 3 TON MODEL)	101623202R	—	—
BLOWER MOTOR (1 HP, 4 & 5 TON MODEL)	—	101623210R	101623216R
BLOWER RELAY COIL (240V)	621931R	621931R	621931R
BLOWER WHEEL (10 X 10)	667207R	667207R	667207R
CAPACITOR (70/7.5/370)	01-0023	01-0023	01-0023
CHARGING PORT CORE (NOT SHOWN)	662103R	662103R	662103R
COIL GUARD (FORMED)	2A8453R	2A8454R	2A8454R
COMPRESSOR (ZP31K5E)	920137	—	—
COMPRESSOR (ZP42K5E)	—	920138	—
COMPRESSOR (ZP54K5E)	—	—	920139
CONTACTOR (3 POLE, 30A W/AUX SWITCH)	621832R	621832R	621832R
CRANK CASE HEATER (NOT SHOWN)	632576	632576	632576
DEFROST BOARD	624733R	624733R	624733R
DEFROST SENSOR (NOT SHOWN)	624740R	624740R	624740R
DRAIN PAN	669190R	669190R	669190R
DRAIN TUBE	663833	663833	663833
DROP-IN ORIFICE	295481R	295481R	295481R
FAN BLADE (24")	667351R	667319R	667319R
FAN MOTOR	622422	622422	622422
FILTER DRIER (8 IN ³)	669762R	669762R	669762R
FILTER RACK ASSEMBLY(NOT SHOWN)	10079930	10079931	10079931
FUSE, 3-AMP (NOT SHOWN)	632261R	632261R	632261R
GROUNDING LUG	632235R	632235R	632235R
HAIL GUARD KIT (NOT SHOWN)	921213	921213	921213
HEX NUT (BLACK) (NOT SHOWN)	606261R	606261R	606261R
HIGH PRESSURE SWITCH (NOT SHOWN)	632473R	632473R	632473R
INDOOR COIL	283091R	D06256R	D06256R
INDOOR DISTRIBUTOR (3 CIRCUIT) (NOT SHOWN)	663913	—	—
INDOOR DISTRIBUTOR (8 CIRCUIT) (NOT SHOWN)	—	663586	663586
LOW PRESSURE SWITCH (NOT SHOWN)	1023983R	1023983R	1023983R
LOW VOLTAGE TERMINAL BLOCK (NOT SHOWN)	632694	632694	632694
MOLDED PLUG (NOT SHOWN)	634718	634718	634718
MOTOR MOUNT KIT	668926R	668926R	668926R
OUTDOOR COIL	D06262R	D06266R	D06266R
OUTDOOR DISTRIBUTOR (4 CIR) (NOT SHOWN)	663581R	—	—
OUTDOOR DISTRIBUTOR (6 CIR) (NOT SHOWN)	—	—	664351
OUTDOOR RESTRICTOR (.053)	664053R	—	—
RELAY COIL (24V)	624617R	624617R	624617R
REVERSING VALVE	669465R	1013956R	1013956R
REVERSING VALVE COIL	669472R	669471R	669471R
SERVICE PORT (BRASS NUT) (NOT SHOWN)	663818R	663818R	663818R
SET OF WIRES (NOT SHOWN)	101623204R	101623204R	101623204R
SWIVEL CONNECTOR (NOT SHOWN)	664194R	—	—
TERMINAL BLOCK (3 POLE)	632348R	632348R	632348R
THERMAL EXPANSION VALVE (INDOOR TXV) (NOTSHOWN)	664343R	664348R	664347R
THERMAL EXPANSION VALVE (OUTDOOR TXV) (NOTSHOWN)	—	664346R	664348R
TOP GRILLE (BLACK)	669335R	669335R	669335R
TOP PAN	M0034707R	M0034707R	M0034707R
TOUCH-UP PAINT (STERLING GREY) (NOTSHOWN)	903598	903598	903598
TRANSFORMER	621850R	621850R	621850R

Please specify the correct Model No., Serial No, and part number(s) when ordering parts from the nearest authorized dealer or service center.

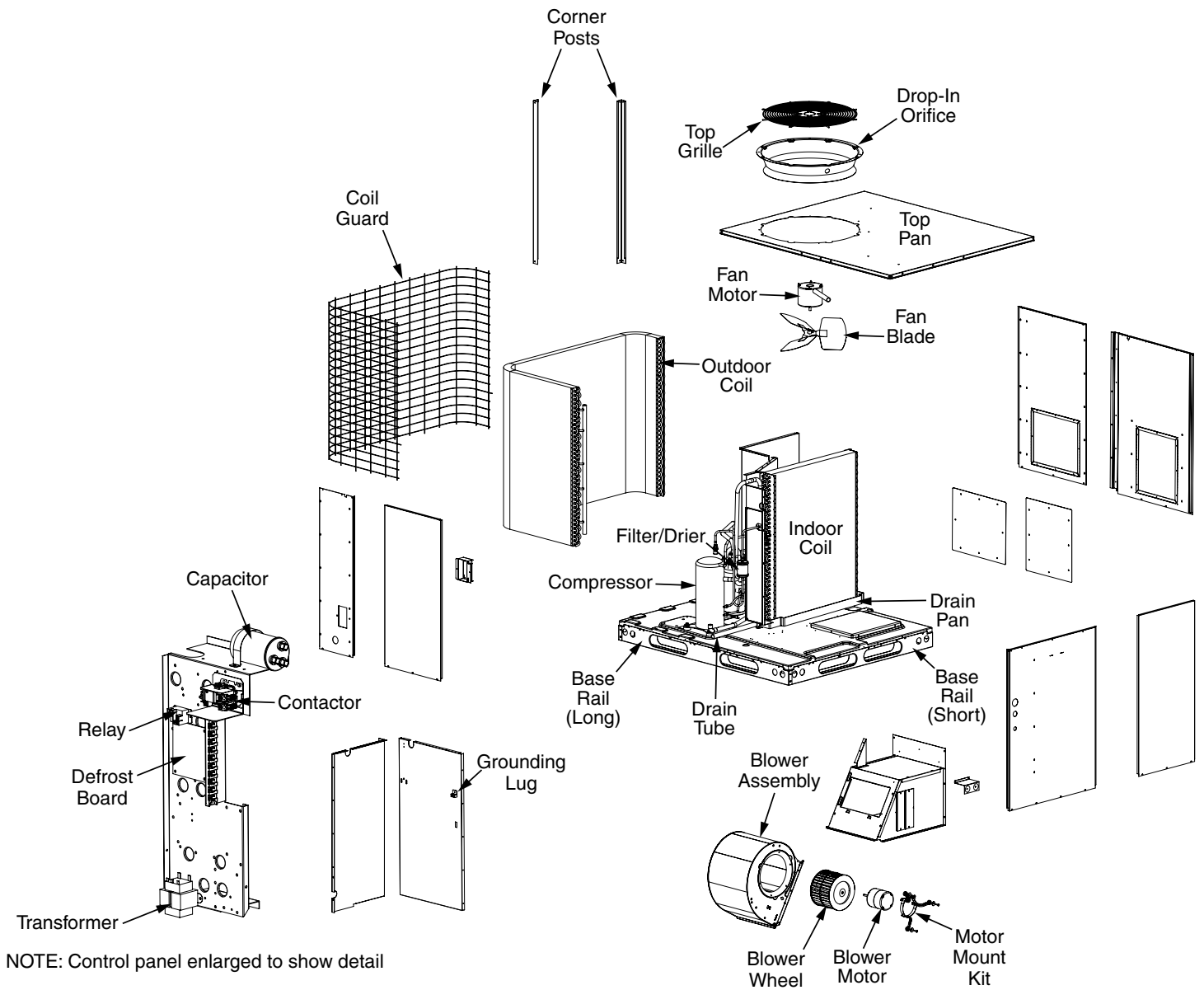

NOTE: Control panel enlarged to show detail

