

REPLACEMENT PARTS LIST

RESIDENTIAL SPLIT SYSTEM HEAT PUMP

PSH1BG4CVRX SERIES

19 SEER MODELS

iQ
Drive[®]

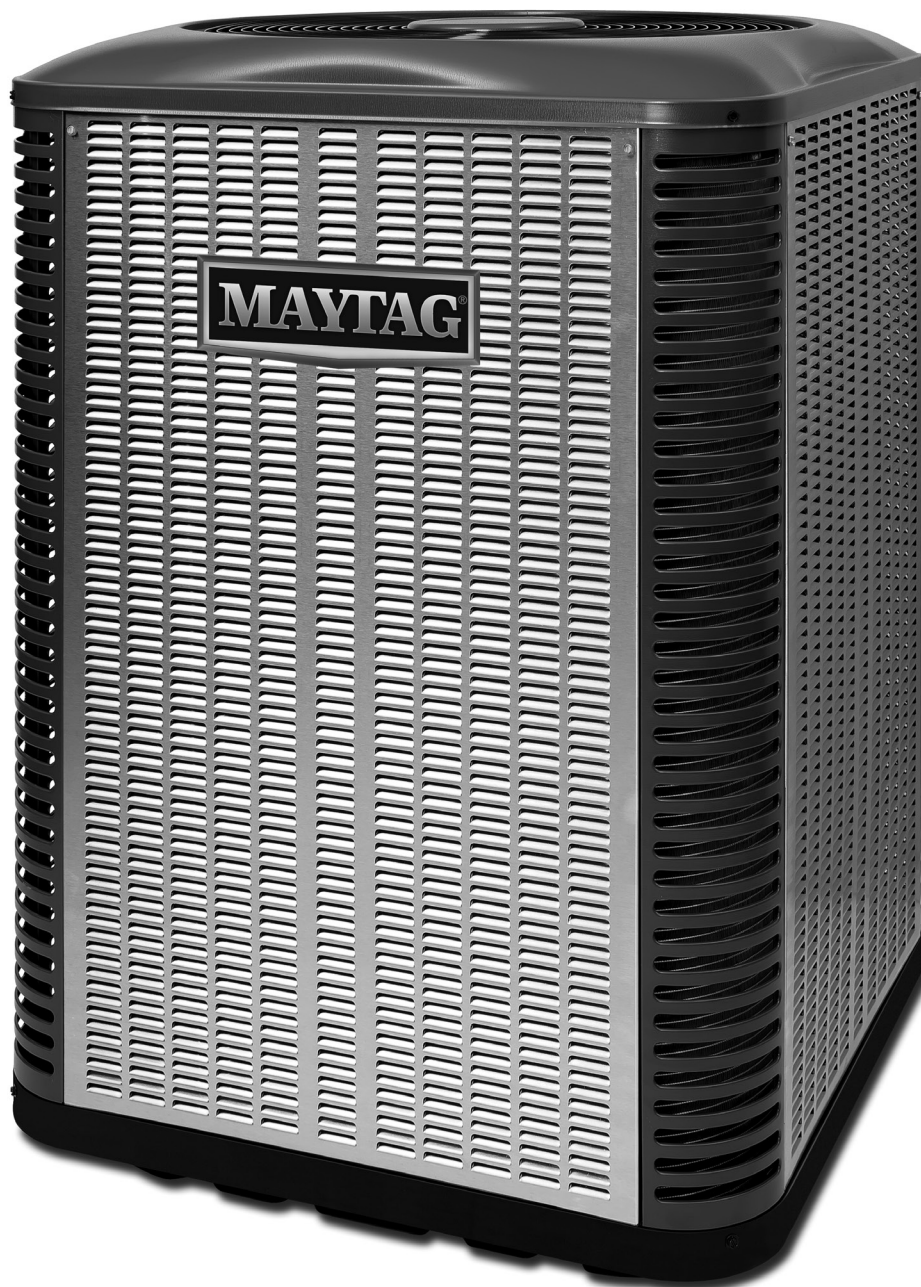

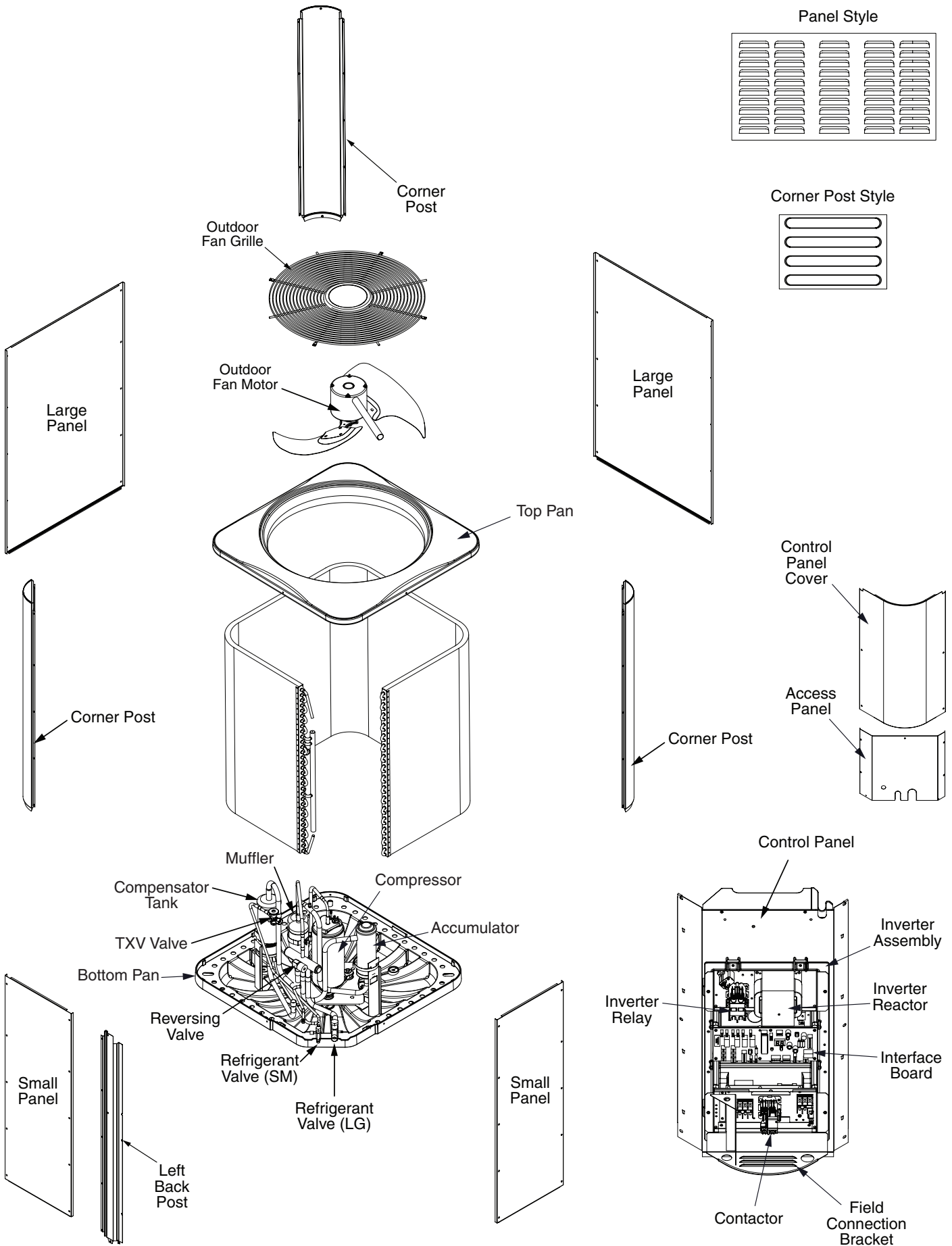

PSH1BG4CVRX SERIES RESIDENTIAL SPLIT SYSTEM HEAT PUMP

DESCRIPTION	PSH1BG4CVRX024K	PSH1BG4CVRX036K	PSH1BG4CVRX048K	PSH1BG4CVRX060K
	1017326P	1017327P	1017328P	1017329P
	1017326PA	1017327PA	1017328PA	1017329PA
ACCESS PANEL	2C1021BR	2C1022BR	2C1022BR	2C1023BR
ACCUMULATOR	669832R	669833R	669833R	669833R
BYPASS AIR FIN	1017816R	1017816R	1017816R	1017816R
COMPENSATOR TANK	669831R	—	669422R	669422R
COMPRESSOR	622515R	622516R	622517R	622518R
COMPRESSOR BASE PAD (NOT SHOWN)	690608R	689975R	689975R	689975R
COMPRESSOR BOLT (NOT SHOWN)	600419R	600428	600428	600428
COMPRESSOR CRANKCASE HEATER (NOT SHOWN)	632538R	632538R	632538R	632538R
COMPRESSOR GROMMET (INCLUDED WITH COMPRESSOR)	669914R	690304R	690304R	690304R
COMPRESSOR SOUND BLANKET (NOT SHOWN)	690526R	690527	690527	690528R
COMPRESSOR POWER WIRE HARNESS	1007620	1007620	1007620	1007619
CONTACTOR	1014864R	1014864R	1014864R	1014865R
CONTROL PANEL (SHEET METAL ONLY)	2C1031R	2C1031R	2C1031R	2C1031R
CONTROL PANEL COVER	101466501BR	101466501BR	101466501BR	101466501BR
CONTROL POWER WIRE HARNESS (5-WIRE) (NOT SHOWN)	2C3592R	2C3592R	2C3592R	2C3592R
FAN MOTOR CONTROL WIRE HARNESS (NOT SHOWN)	634827	634827	634827	634827
FAN MOTOR POWER WIRE HARNESS (NOT SHOWN)	634826	634826	634826	634826
FAN MOTOR WIRE CONDUIT (NOT SHOWN)	664290	664290	664290	664290
FIELD CONNECTION BRACKET (SHEET METAL WITH LOUVERS)	2C0991BR	2C0991BR	2C0991BR	2C0991BR
FIELD WIRING HARNESS, (6-WIRE) (NOT SHOWN)	2C6131R	2C6131R	2C6131R	2C6131R
FILTER DRIER (NOT SHOWN)	669761R	669761R	669761R	669761R
INVERTER ASSEMBLY	1044114	1044115	1044116	1044117
INVERTER INTERFACE BOARD (INCLUDED WITH INVERTER ASSY)	624767R	624768R	624769R	624770R
INVERTER REACTOR (INCLUDED WITH INVERTER ASSY)	624795R	624795R	624796R	624797R
INVERTER RELAY (INCLUDED WITH INVERTER ASSY)	—	—	—	624803R

Please specify the correct Model No. , Serial No., and part number(s) when ordering parts from the nearest authorized Dealer or Service Center.

PSH1BG4CVRX SERIES iQDrive RESIDENTIAL SPLIT SYSTEM HEAT PUMP

DESCRIPTION	PSH1BG4CVRX024K	PSH1BG4CVRX036K	PSH1BG4CVRX048K	PSH1BG4CVRX060K
	1017326P	1017327P	1017328P	1017329P
	1017326PA	1017327PA	1017328PA	1017329PA
JACKET, CORNER POST	101472304BR	101472305BR	101472305BR	101472306BR
JACKET, LARGE PANELS	101074204SR	101074205SR	101074205SR	101074206SR
JACKET, LEFT BACK POST	101450404BR	101450405BR	101450405BR	101450406BR
JACKET, RIGHT BACK POST	101450304BR	101450305BR	101450305BR	101450306BR
JACKET, SMALL PANELS	101074404SR	101074405SR	101074405SR	101074406SR
MUFFLER	669546R	669546R	669546R	669546R
OUTDOOR COIL (FORMED)	2B8781R	2B8782R	2B8783R	2B8784R
OUTDOOR FAN BLADE	667351R	667351R	667351R	667351R
OUTDOOR FAN GRILLE	1034992R	1034992R	1034992R	1034992R
OUTDOOR FAN MOTOR	1006719R	1006719R	1006719R	1006720R
REFRIGERANT SERVICE VALVE (LIQUID)	663862R	663862R	663862R	663862R
REFRIGERANT SERVICE VALVE (VAPOR)	663864R	663865R	663865R	663865R
REVERSING (4-WAY) VALVE	669465R	1034696R	1034696R	1034696R
REVERSING VALVE COIL & WIRE HARNESS (NOT SHOWN)	669470R	669470R	669470R	669470R
SWITCH, HIGH PRESSURE (NOT SHOWN)	632473R	632473R	632473R	632473R
SWITCH, LOW PRESSURE (NOT SHOWN)	632634R	632634R	632634R	632634R
TEMPERATURE SENSOR, AMBIENT (BLACK) (NOT SHOWN)	624780R	624780R	624780R	624780R
TEMPERATURE SENSOR, COIL (YELLOW) (NOT SHOWN)	624781R	624781R	624781R	624781R
TEMPERATURE SENSOR, COMPR. DISCHARGE (RED) (NOT SHOWN)	624779R	624779R	624779R	624779R
TEMPERATURE SENSOR, DEFROST (WHITE) (NOT SHOWN)	624793R	624793R	624793R	624793R
TEMPERATURE SENSOR, SUCTION (BLUE) (NOT SHOWN)	624782	624792R	624792R	624792R
TOP PAN	101472501BR	101472101BR	101472101BR	101472101BR
TXV (THERMOSTATIC EXPANSION VALVE)	669956R	669957R	669958R	669958R

Please specify the correct Model No. , Serial No., and part number(s) when ordering parts from the nearest authorized Dealer or Service Center.

